

## 1 Functions and characteristics

SLJ wheel manual test stand, specially designed to match SN,SH/SP (Sensor Inside) series push pull force gauges, is applied in various industry and scientific research organization for testing, such as tension/compression test, insertion/withdraw test and fracture test. It adapts T-screw driver and holistic nut design. It is manual operation, sample and stable, both vertical and horizontal using.

- Dimension:  
L×W×H (mm) 154×240×467
- Capacity :500N; Stroke: 150mm
- Applied with(Purchase additionally):  
SN,SH/SPseries (Sensor inside)  
push pull force gauge, various clamps.

## 2 Structure



SLJ Wheel manual test stand

Note:SN push pull force gauge should purchase additionally.

## 3 The installation of the test stand

1. Put the test stand on level working table, use 7 adjusted screws to keep it in order to get the accurate test value. You can also fix the test stand on the worktable to make it more steady by using screws holes on the base plate. You can install the test stand as your request when testing. Please refer to the dimension in following picture to install:

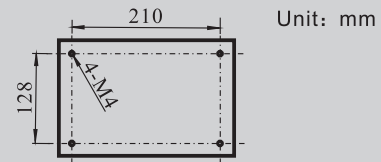

a. Vertical installment by using 4-M4 screw on the base plate.

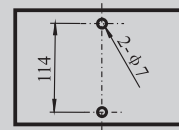

b. Vertical installment by using 2-φ7 holes on the base plate;

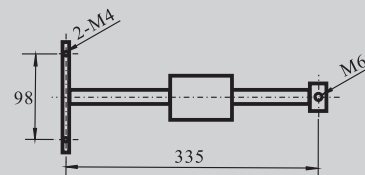

c. Horizontal installment by using 2-M4 screws on the base plate and M6 screw on the beam of test stand;

2. The installation with gauge: install the gauge by rear panel on the stand, indication picture as follows:

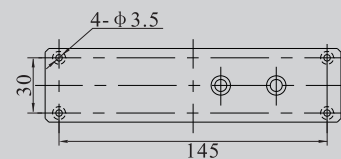

3. The installation of SN analog force gauges: Take down 4 pieces of M3 x 8 screws on the rear panel of SN, use 4 pieces of M3 x 14 screws to screw the force gauge by the holes on rear panel, then tighten it.

4. The installation of SH/SP push pull force gauge: Take out the 4 pieces of M3 x 8 screws from package box. Screw the force gauge by the holes on rear panel, tighten it. The indication as follows:

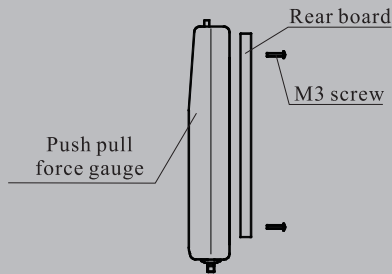

Installation of push pull force gauge

## 4 Measurement

It tests push and pull forces bidirectionally. First put or install the tested sample on suitable position of the working table in accordance with the samples characteristics, adjust the height. Then move the hand wheel of the test stand. The force gauge will move up and down to complete the test.

## 5 Cautions

1. Do not overload testing capacity. Otherwise it will cause destroy to the stand. The max capacity is 500N.
2. Handle carefully when using and carrying.
3. Do not use it near water, oil or others liquid.
4. Clean dirt and dust for gauge with soft cloth. After dipping cloth in the neutral detergent water and squeeze out water for cleaning. Do not use volatile chemical liquid to clean it. such as benzene, thinner, alcohol etc.
5. Never disassemble, repair and remode the stand by yourself, or it will cause perpetual destroy.

## 6 Packing list

Number	Name	Quantity
1	SLJ Main body	1
2	M6×25 Double-head screw	1
3	M6 nut	1
4	Hook	1
5	Manual	1
6	Certification	1

### WENZHOU SUNDOO INSTRUMENTS CO.,LTD

Add:No.5,Xigongxi Road,Xitai Industrial Zone,  
Wenzhou China

Zip Code: 325011

TEL:+86 577 88609905

FAX:+86 577 88390155

Http://www.sundoo.com

E-mail:export@sundoo.com